

June 4, 2007
FOR IMMEDIATE RELEASE

CONTACT: John Ihle, project developer (701) 261-7581

TODD COUNTY COMMUNITY WELCOMES GERMAN TURBINE MANUFACTURER

HEWITT, Minn.—The award-winning Bertha-Hewitt High School marching band will lead a procession of local and state dignitaries who will welcome German wind turbine manufacturer Nordex to Hewitt, Minn., during a rally Friday, June 8 beginning at 11:00 a.m. Nordex selected Hewitt (population 268) as the first North American site for deployment of its 2.5 megawatt wind turbine and the city is planning a large welcoming ceremony.

The new Hewitt turbine will be Minnesota's largest. Standing nearly 300 feet tall, it is expected to be operational for attendees to view on June 8. If the first turbine testing is successful, plans are to install 12 additional turbines at the site. Regional electric utility Minnesota Power is purchasing all of the output from the C-BED (community-based energy development) facility.

Besides the annual Hewitt Pickle Festival held each July, the June 8 event is sure to be one of the most exciting events in town this year. The community is excited to be associated with Nordex, a multi-national corporation with ambitious global growth plans. Several top Nordex executives from Germany will be in Hewitt to join in the celebration.

In operation since 1985, Nordex is a global developer and manufacturer of wind turbines. Nordex has installed nearly 3,000 commercial wind turbines presently operating in 33 countries with a total rated output of more than 3,273 megawatts. Nordex maintains its headquarters in Rostock, Germany. More information about the company is available at www.nordex-online.com.

Approximately 175 miles from Minneapolis, Hewitt is located in west central Minnesota near the intersection of state highways 71 and 210 in the northwest corner of Todd County.

###

T133N R35W
STOWE PRAIRIE
TOWNSHIP
SECTION 8

Check with
Hewitt & Verdale
Post Offices for mail service

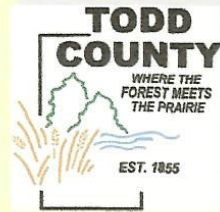

911 ADDRESSING

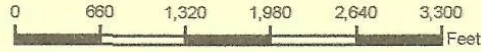

Todd County GIS & Land Services
347 Central Ave - Suite 1
Long Prairie, MN 56347
(phone) 320-732-4248
March 29, 2007

The Todd County GIS & Land Services Department has made every effort to provide the most accurate and up-to-date information available in this publication and cannot be held responsible for any unforeseen errors or omissions.

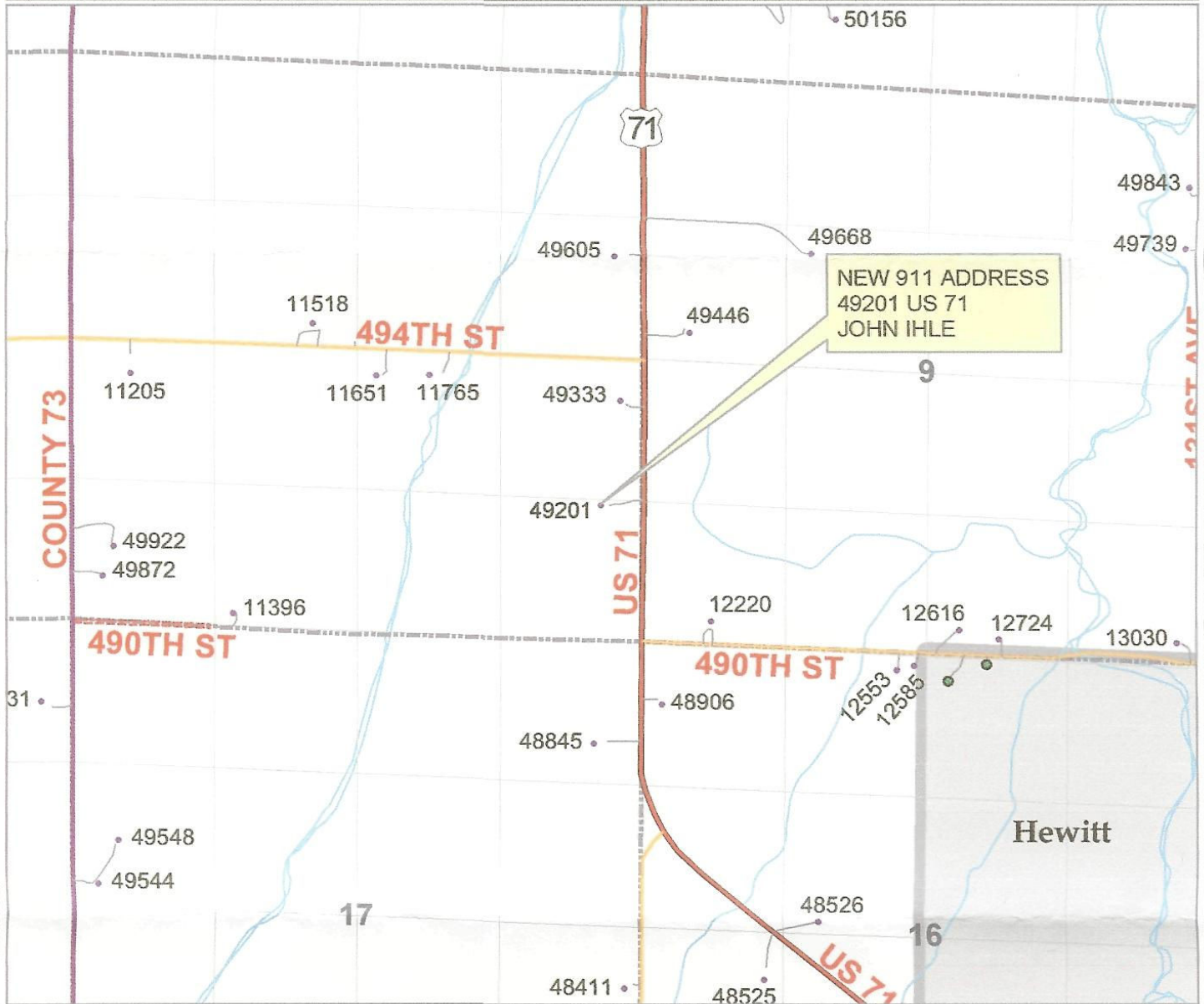

PARCEL ADDRESS INFORMATION

PARCEL# : 23-0006700

NOTES :

911 ADDRESS : 49201 US 71

TAXPAYER : JOHN IHLE

TAXPAYER2 :

MAILING ADDRESS : 27451 SOUTH HWY 34

CITY, ST : BARNESVILLE, MN

ZIPCODE : 56514

For Office Use Only:

| | |
|---|---|
| <input type="checkbox"/> site check / GPS | <input type="checkbox"/> # blades used |
| <input type="checkbox"/> GPS processed | <input type="checkbox"/> 6' post |
| <input type="checkbox"/> maps updated | <input type="checkbox"/> 8' post |
| <input type="checkbox"/> notification | <input type="checkbox"/> 9' post |
| <input type="checkbox"/> AS400 updated | <input type="checkbox"/> 990f bracket |
| <input type="checkbox"/> staked for Gopher | <input type="checkbox"/> 91uf bracket |
| <input type="checkbox"/> Gopher Locate ticket | <input type="checkbox"/> nuts |
| <input type="checkbox"/> sign installed | <input type="checkbox"/> bolts |
| <input type="checkbox"/> billing database | <input type="checkbox"/> washers |
| <input type="checkbox"/> filed | <input type="checkbox"/> allen bolts |
| | <input type="checkbox"/> used existing hardware |